



# REGIONE PUGLIA



## Comune di Cagnano Varano Provincia di Foggia

Lavori di ampliamento della rete idrica a servizio  
della frazione di Capojale e Isola Varano

### PROGETTO ESECUTIVO

IL PROGETTISTA:

A.T.P.: "Studio AC3 Ingegneria s.r.l." ed altri

Dott. Ing. Raffaele CAGNAZZI



STUDIO AC3 Ingegneria s.r.l.

- Via Pertini n°2, 76017 S. Ferdinando di P.(BT)

- Tel/Fax 0883/623802. E-MAIL studioac3@tiscali.it

(capogruppo mandatario)



TAVOLA:

**B9.2**

SCALA:

1:50

DATA:

Agosto 2013

IL COMMITTENTE:

Amministrazione Comunale

IL SINDACO  
(Dr. Nino TAVAGLIONE)

R.U.P.:

Arch. Antonio DI NAUTA



Il Responsabile U.T.C.  
Arch. Antonio DI NAUTA

DESCRIZIONE ELABORATO:

Particolari costrittivi attraversamenti canali



**SINCERT**

Sistema Certificato  
UNI EN ISO 9001:2008  
SC 09-1821/EA 34

Affiliato



CODICE PROGETTO:

REVISIONE:

Rev. 0

**PARTICOLARE COSTRUTTIVO ATTRAVERSAMENTO CANALE N°1 Km 2,640**  
 scala 1:50

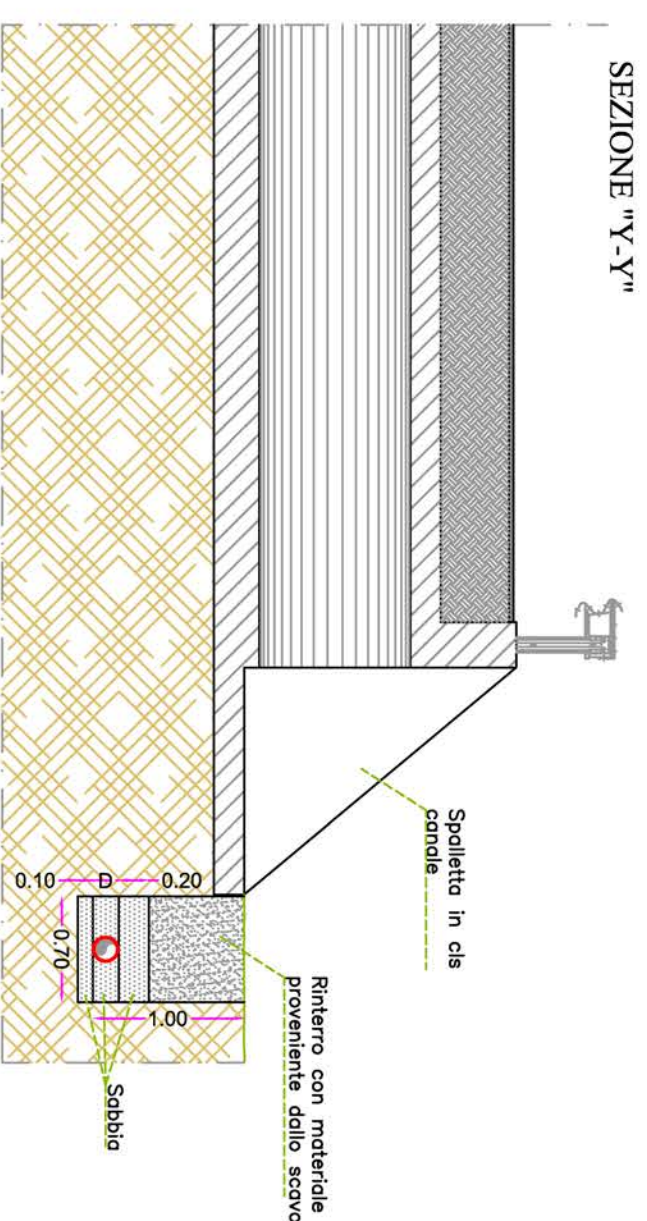
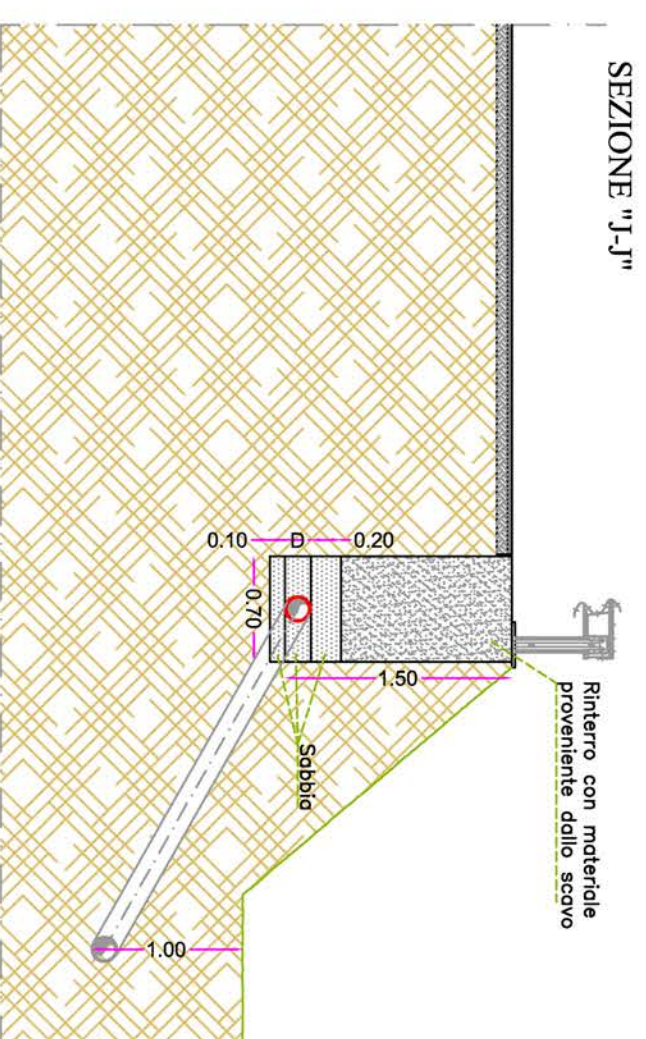
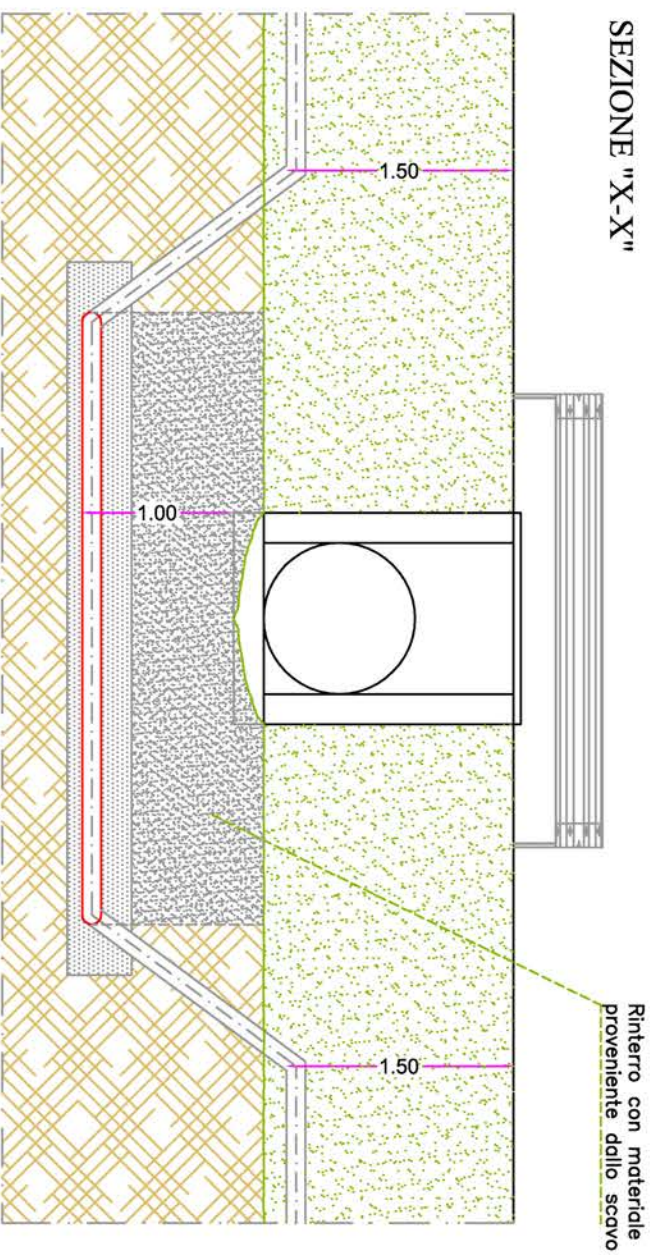
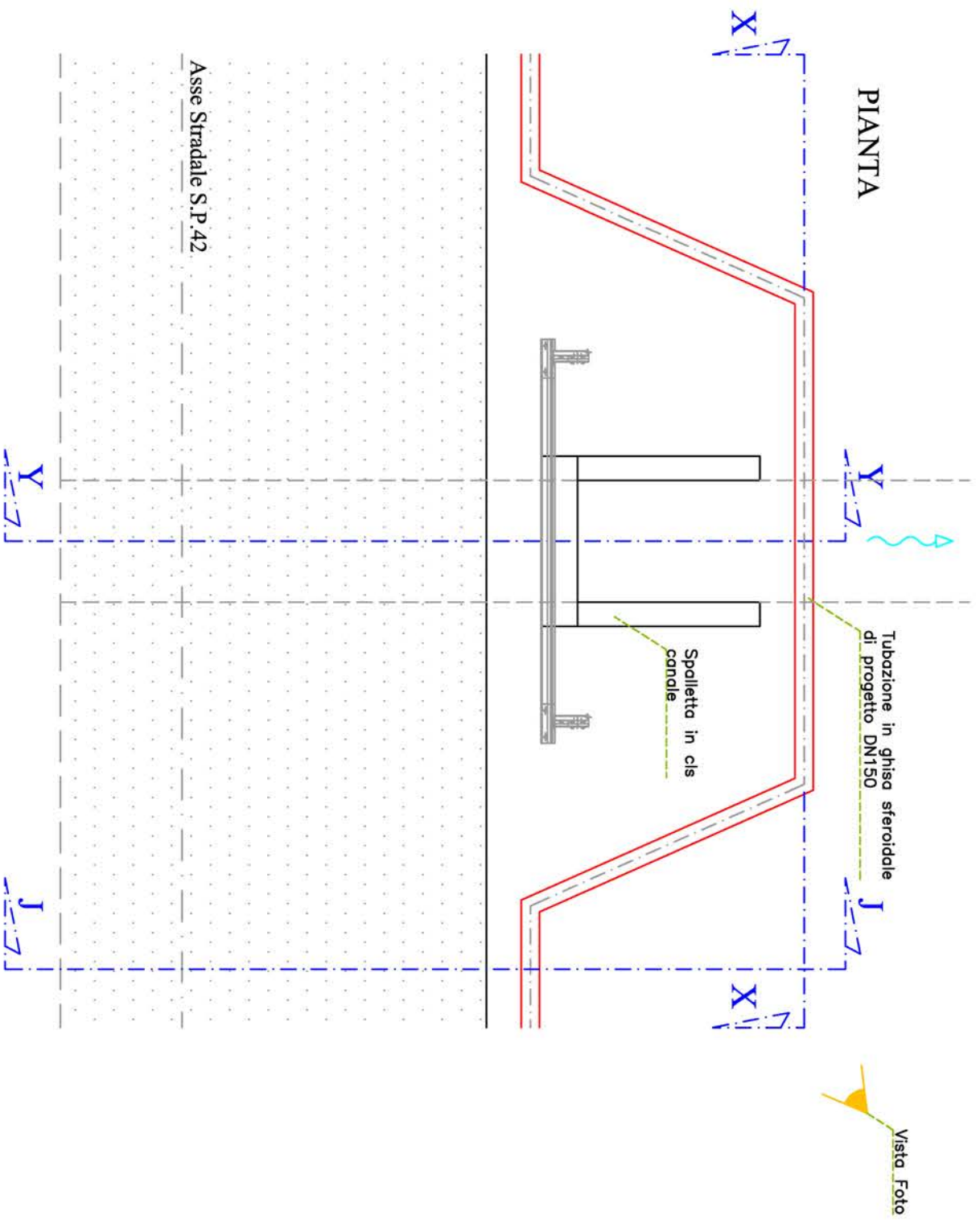

**PARTICOLARE COSTRUTTIVO ATTRAVERSAMENTO CANALE N°2 Km 3,630**  
 scala 1:50

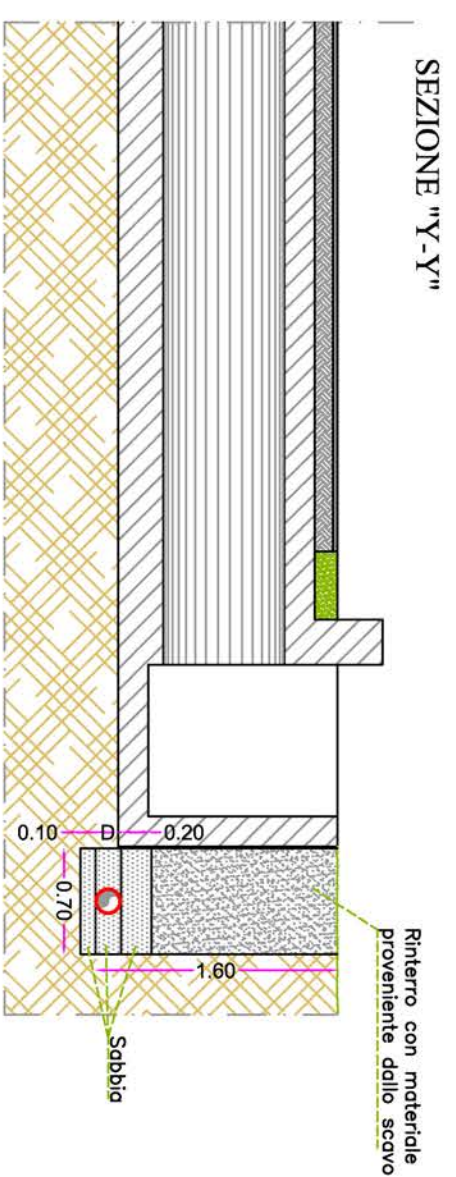
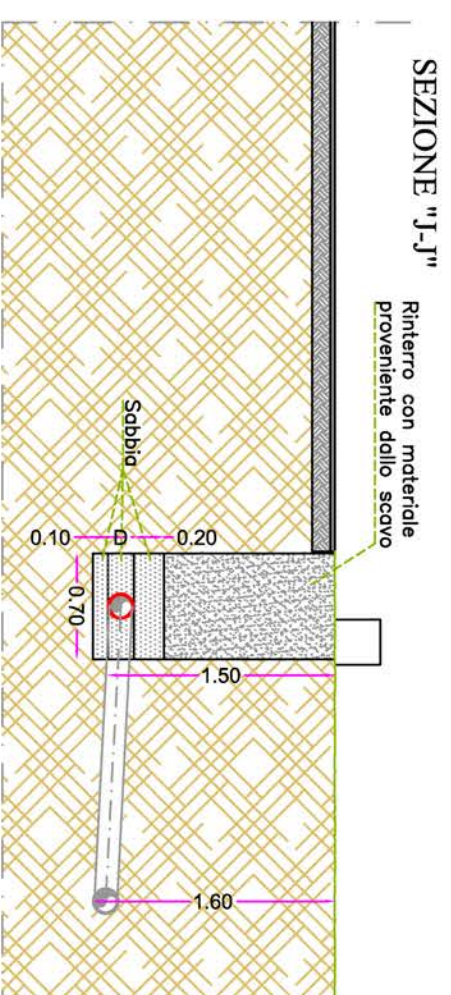
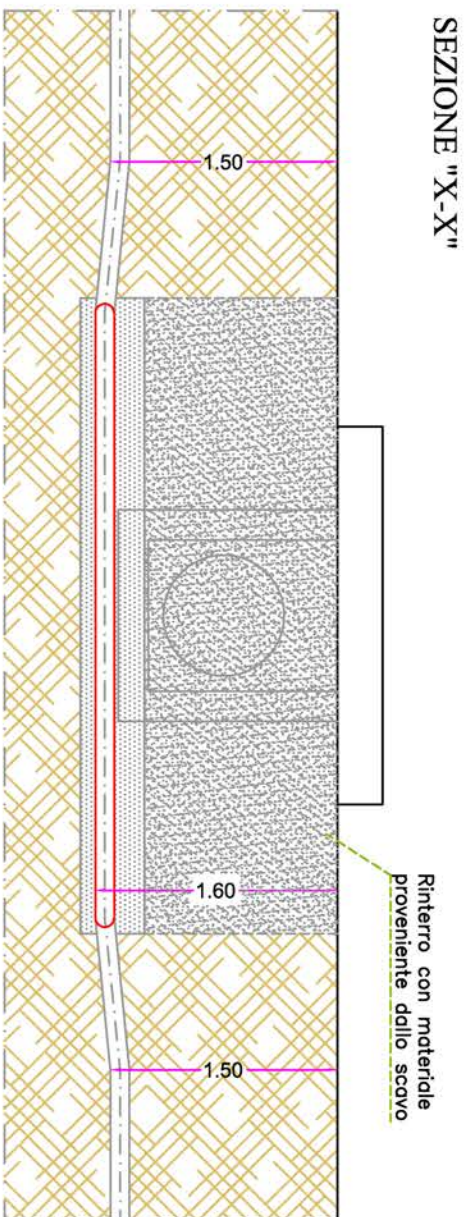
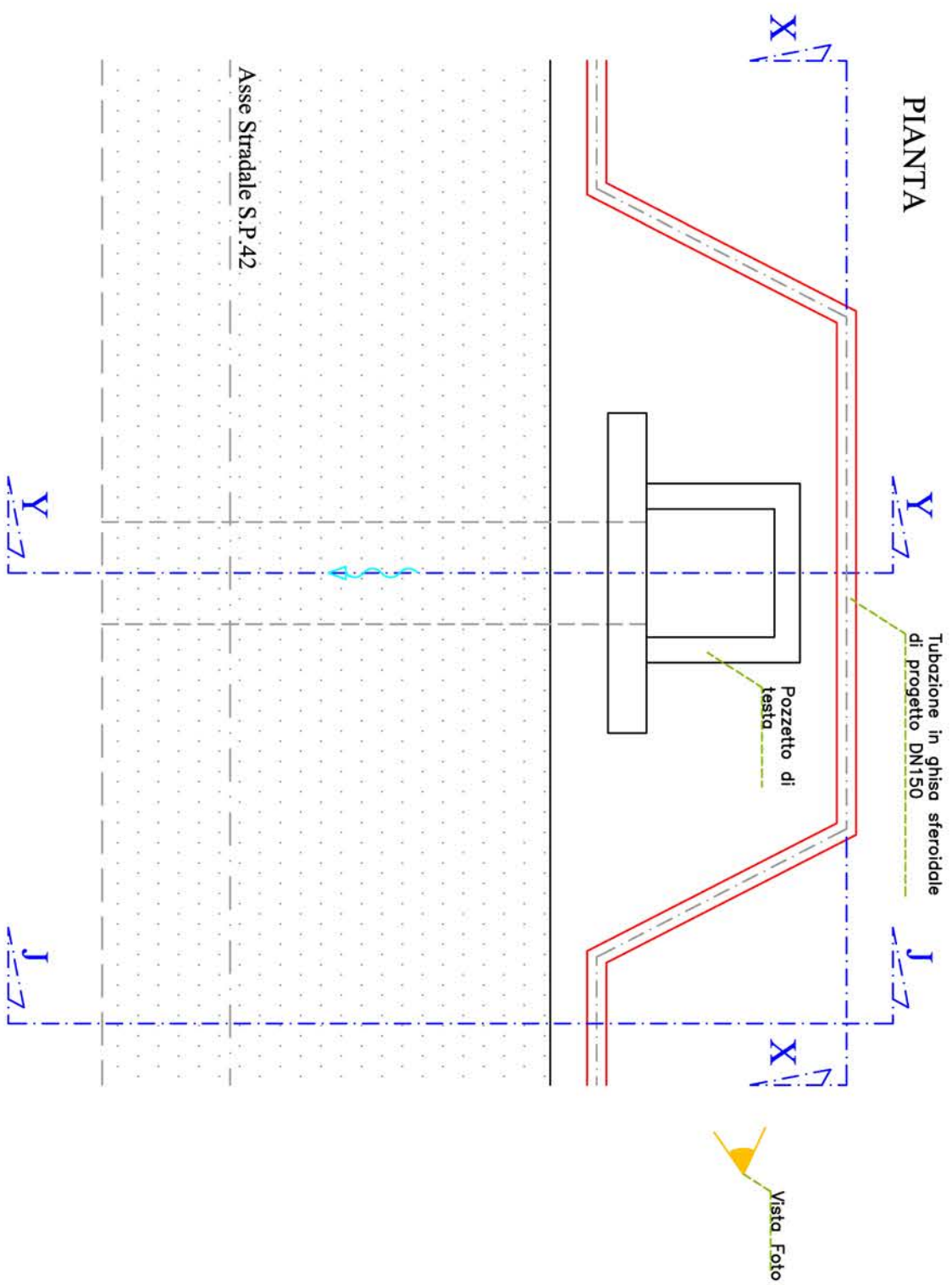

PARTICOLARE COSTRUTTIVO ATTRAVERSAMENTO CANALE N°3 Km 4,610  
scala 1:50

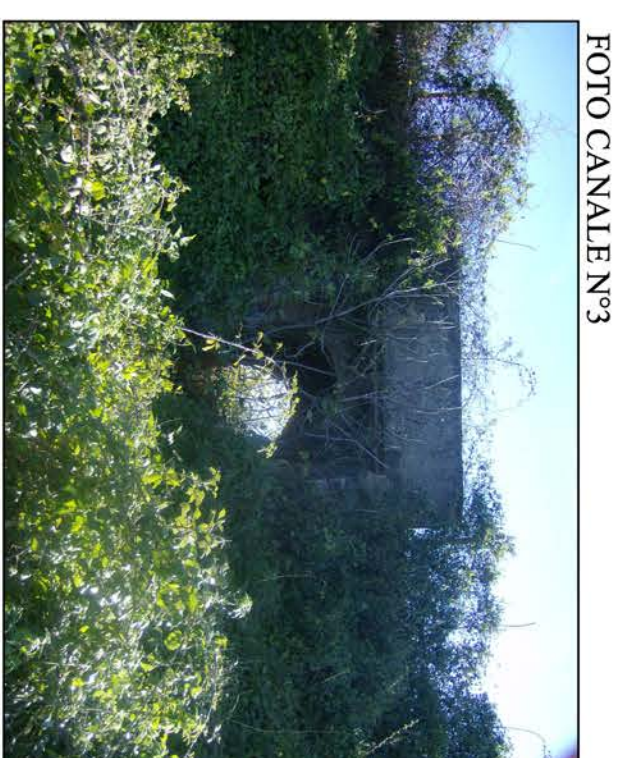
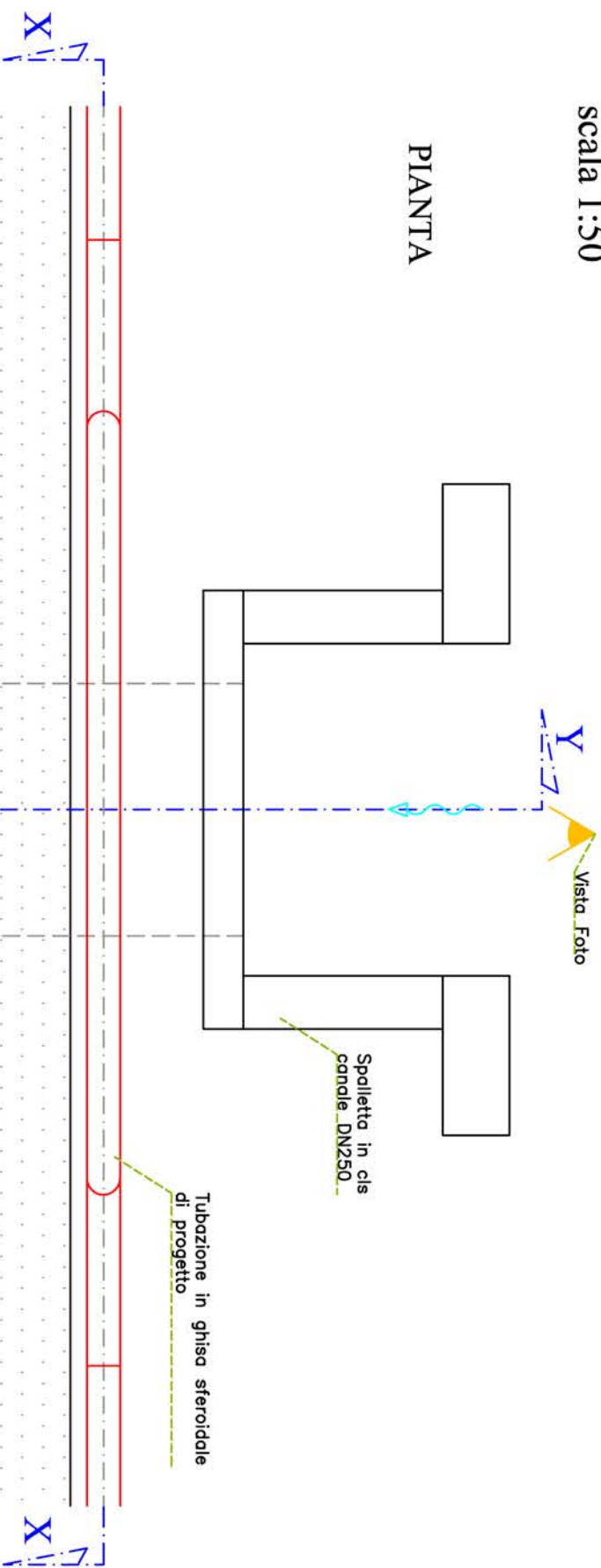

Asse Stradale S.P.42

SEZIONE "X-X"

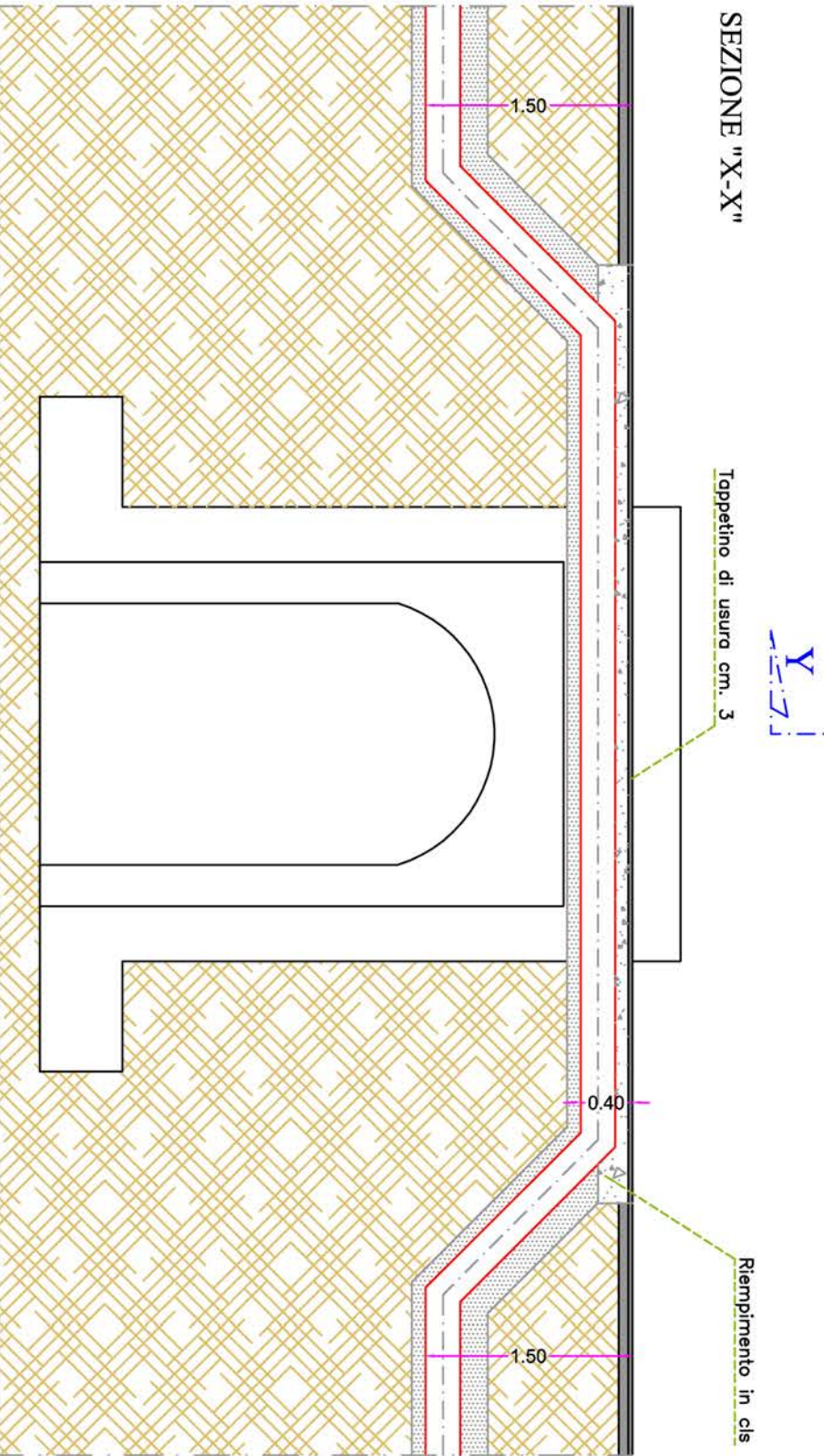

SEZIONE "Y-Y"

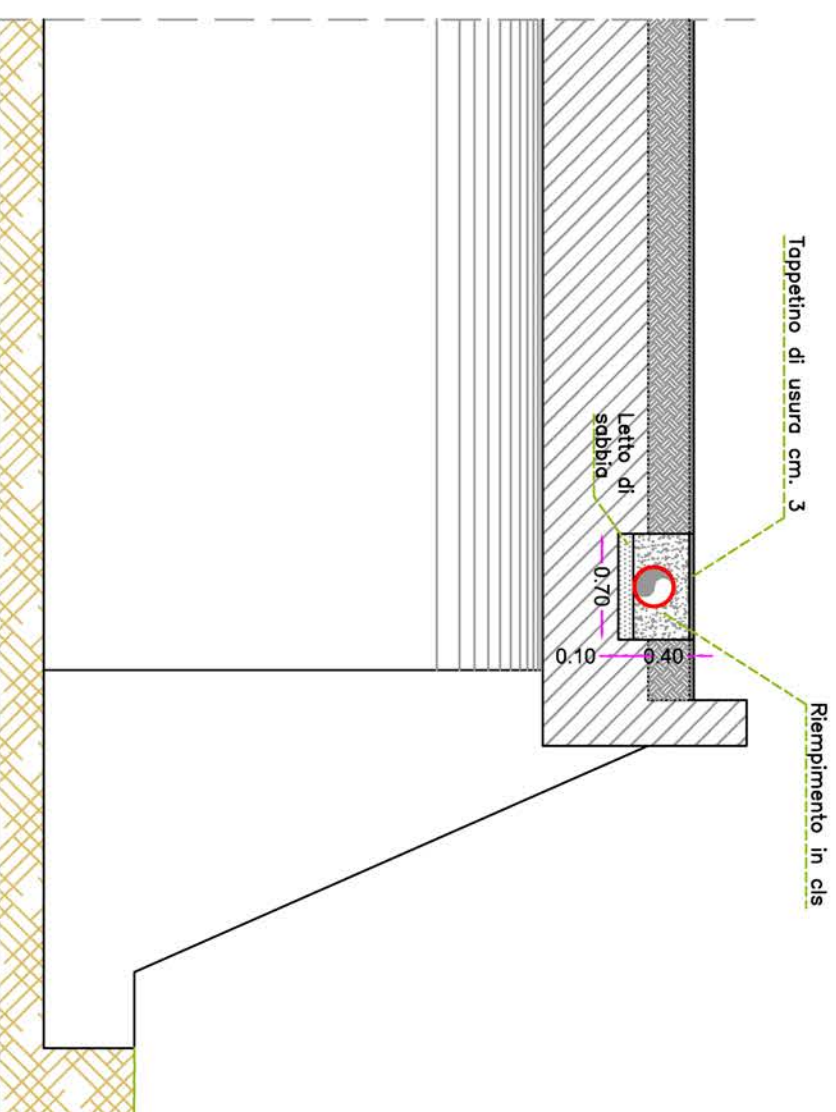

**PARTICOLARE COSTRUTTIVO ATTRAVERSAMENTO CANALE N°4 Km 5,050**  
 scala 1:50

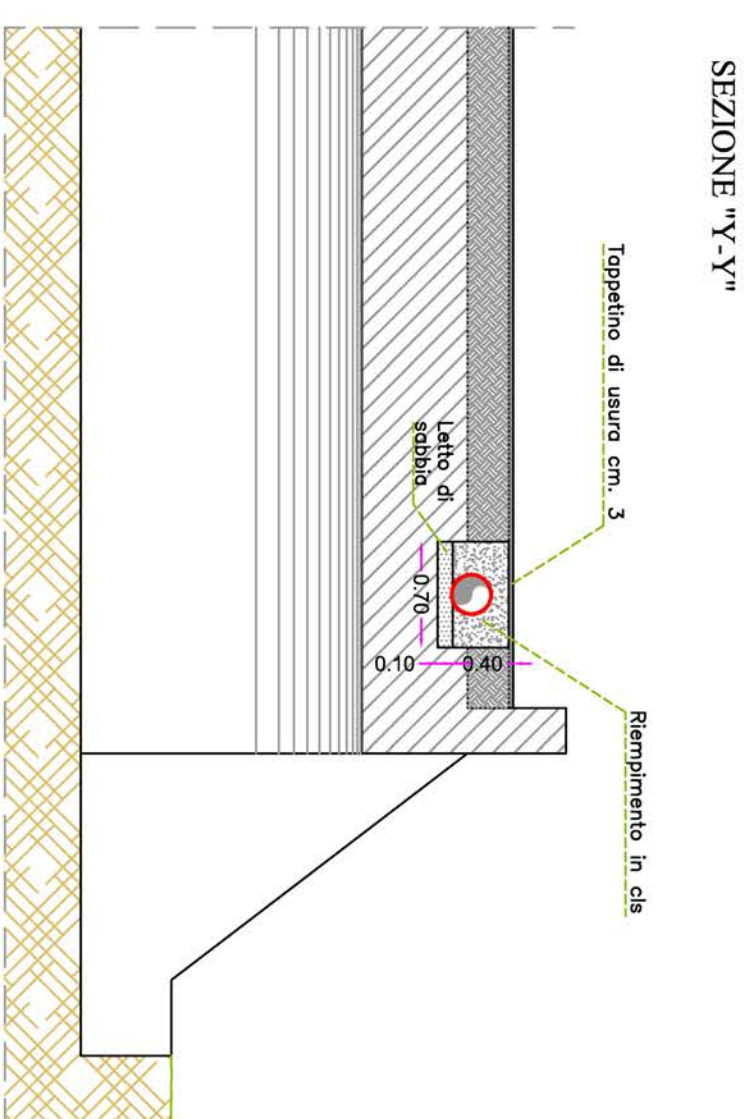
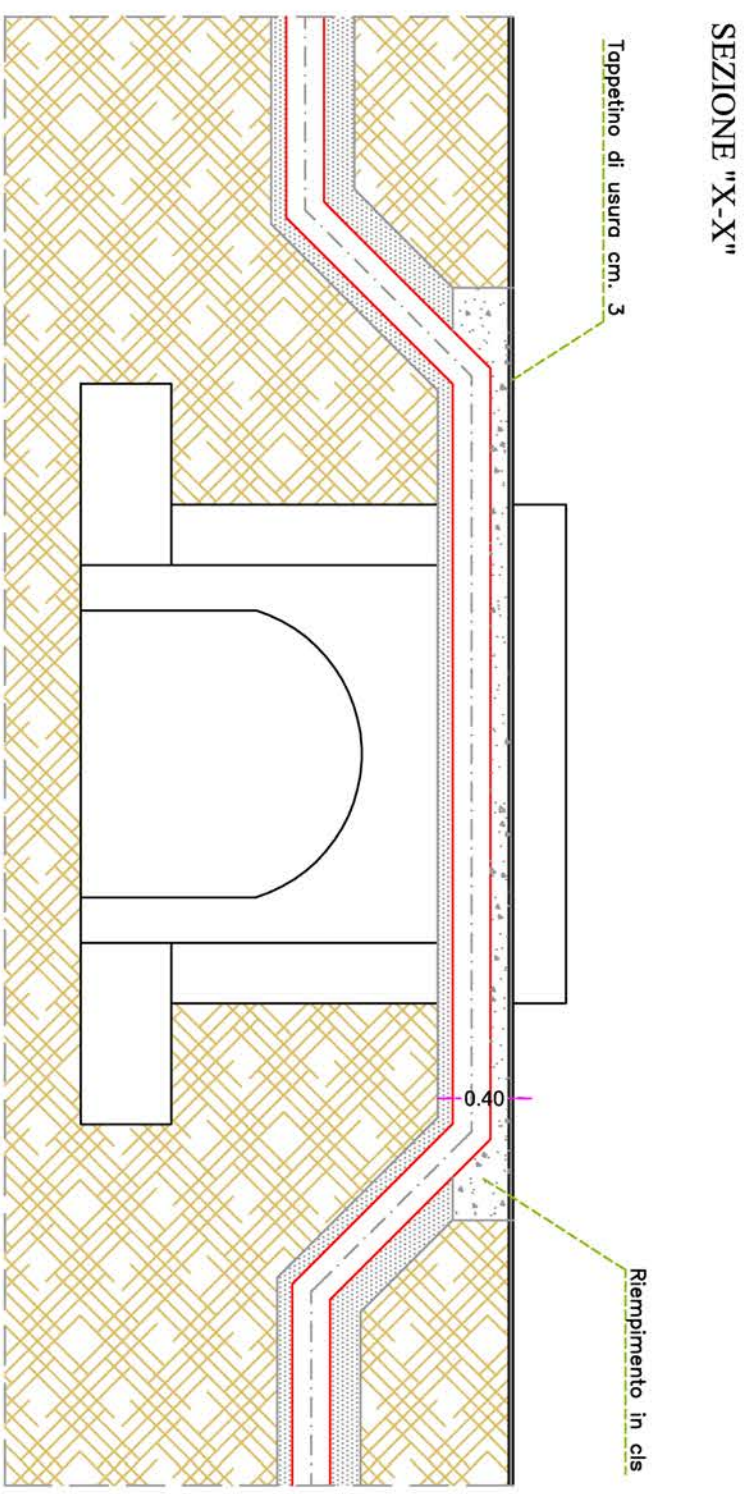
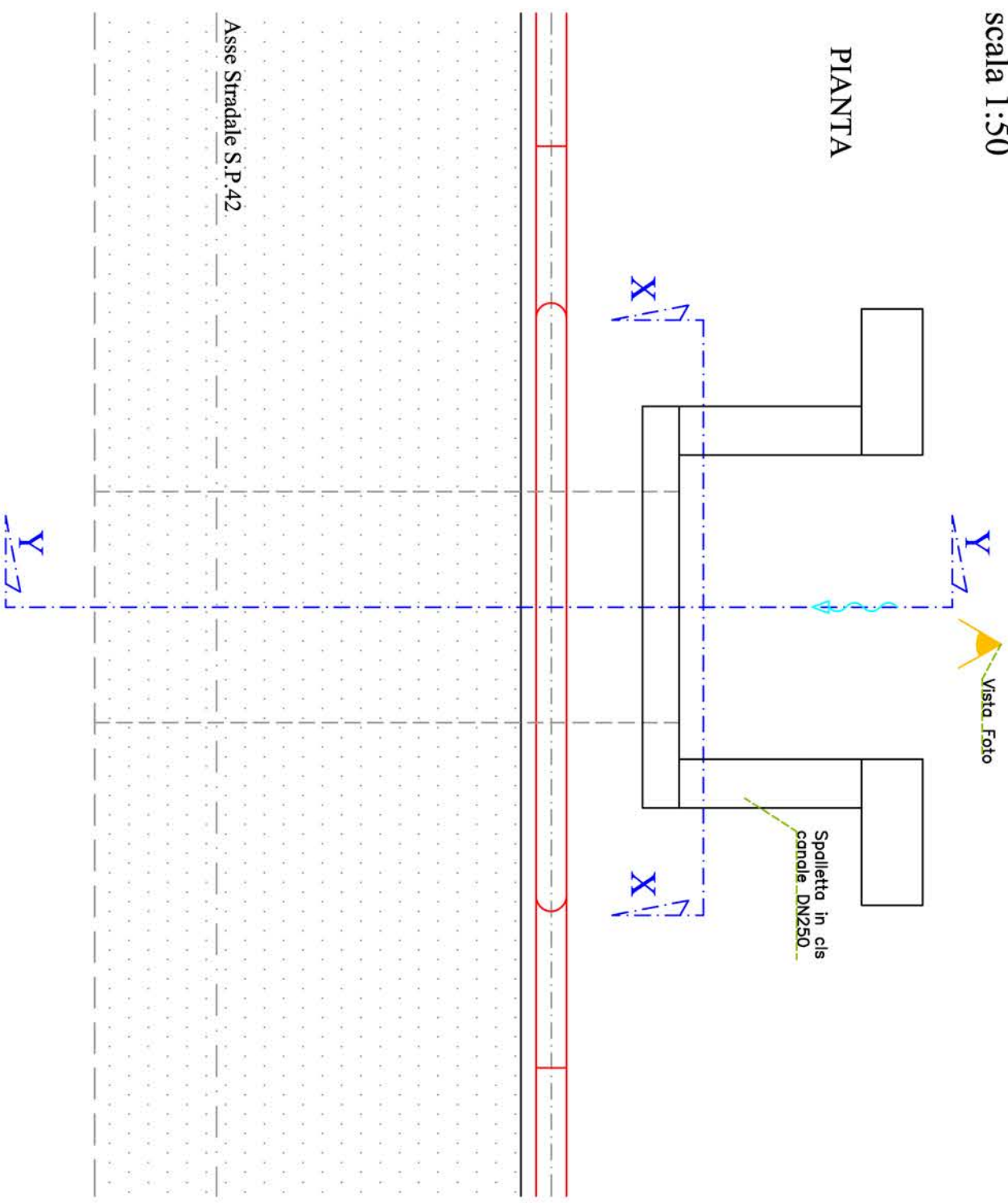

**PARTICOLARE COSTRUTTIVO ATTRAVERSAMENTO CANALE N°4a Km 5,618**  
 scala 1:50

**PIANTA**



FOTO CANALE N°4a

**SEZIONE "X-X"**



**SEZIONE "J-J"**

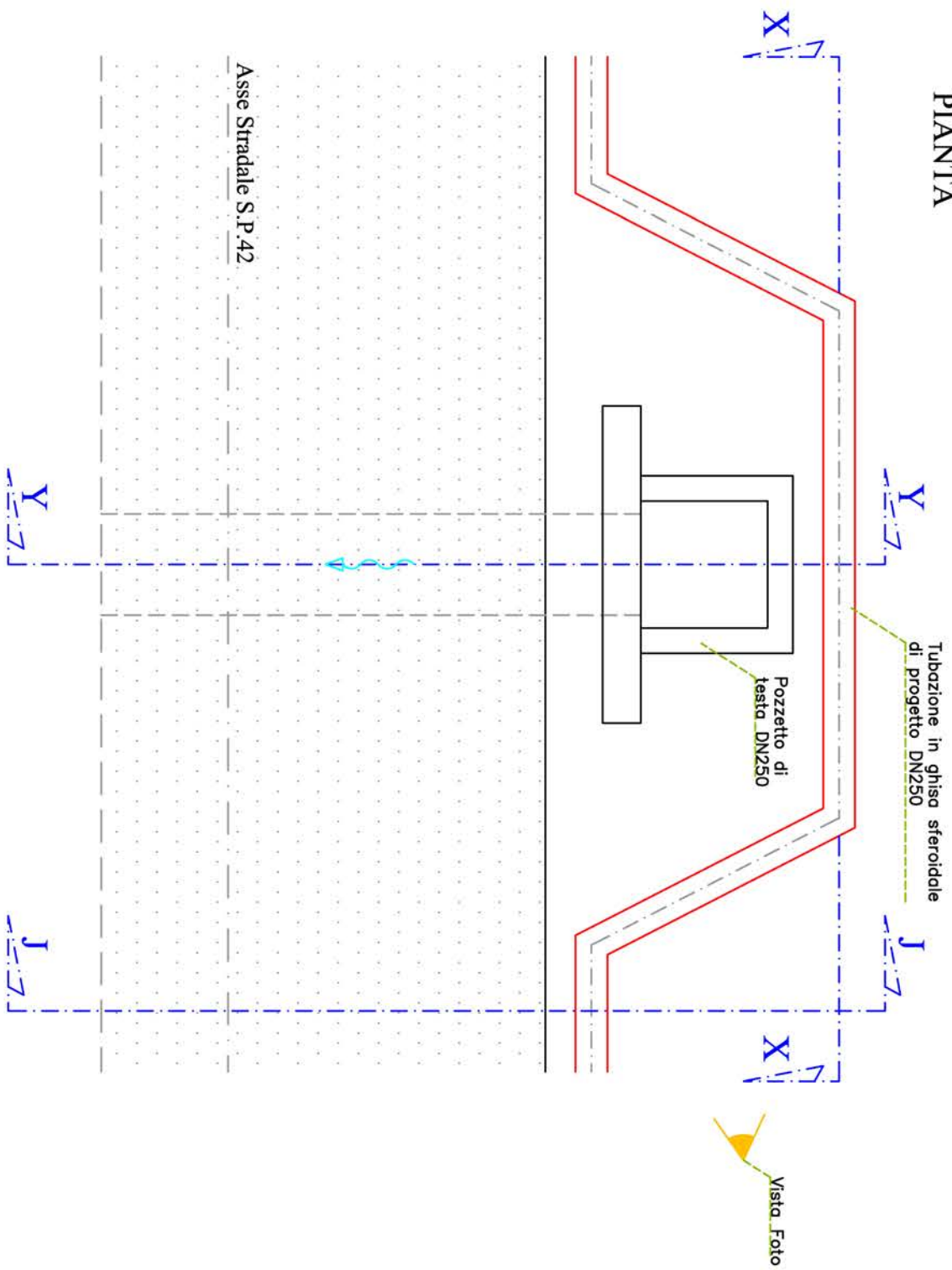
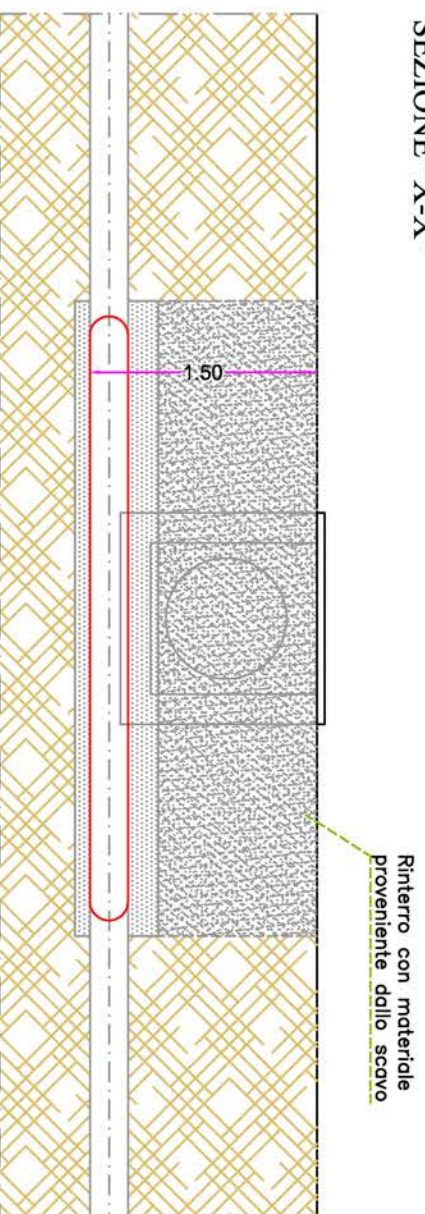
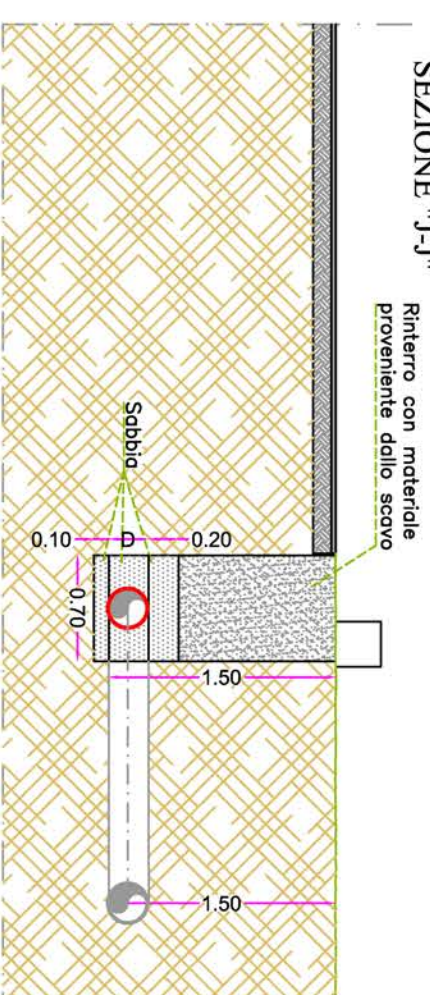

**SEZIONE "Y-Y"**

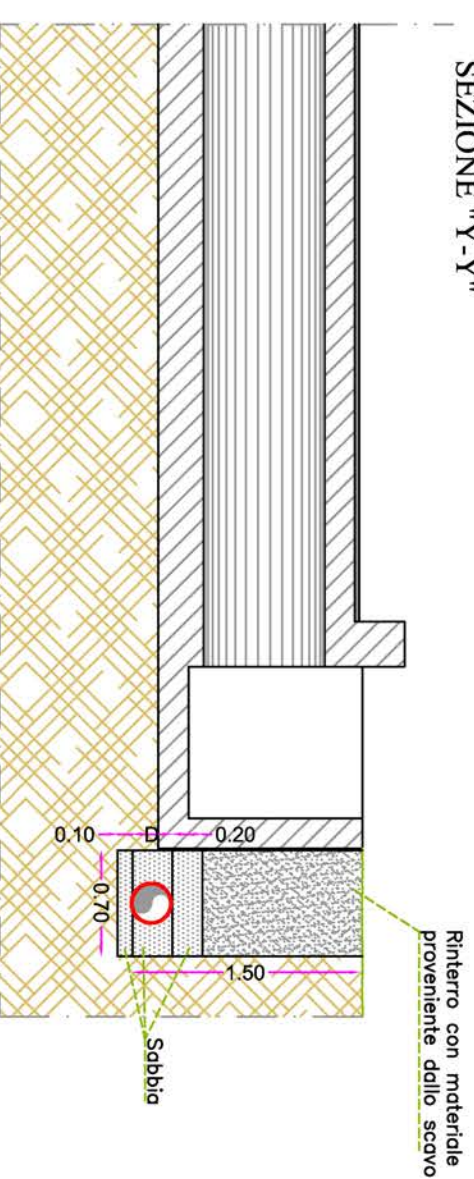

**PARTICOLARE COSTRUTTIVO ATTRAVERSAMENTO CANALE N°5 Km 5,905**  
 scala 1:50

PIANTA

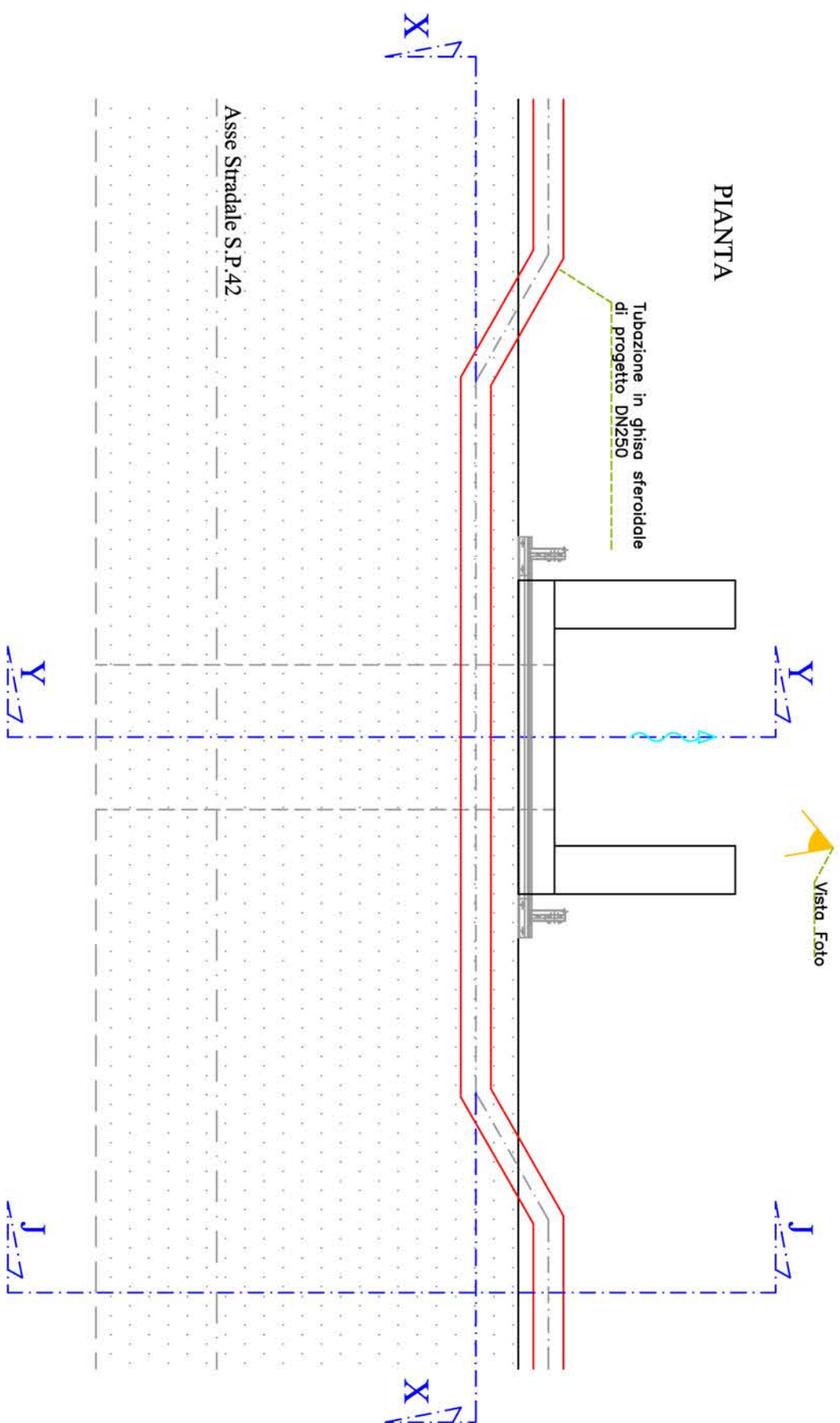

Asse Stradale S.P.42

SEZIONE "X-X"



FOTO CANALE N°5



SEZIONE "J-J"

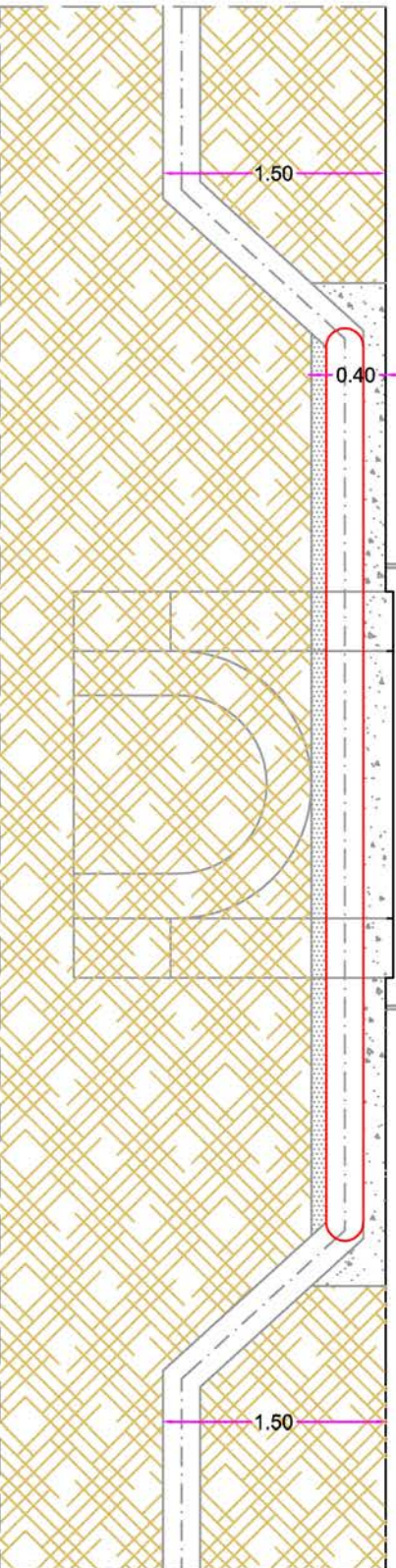
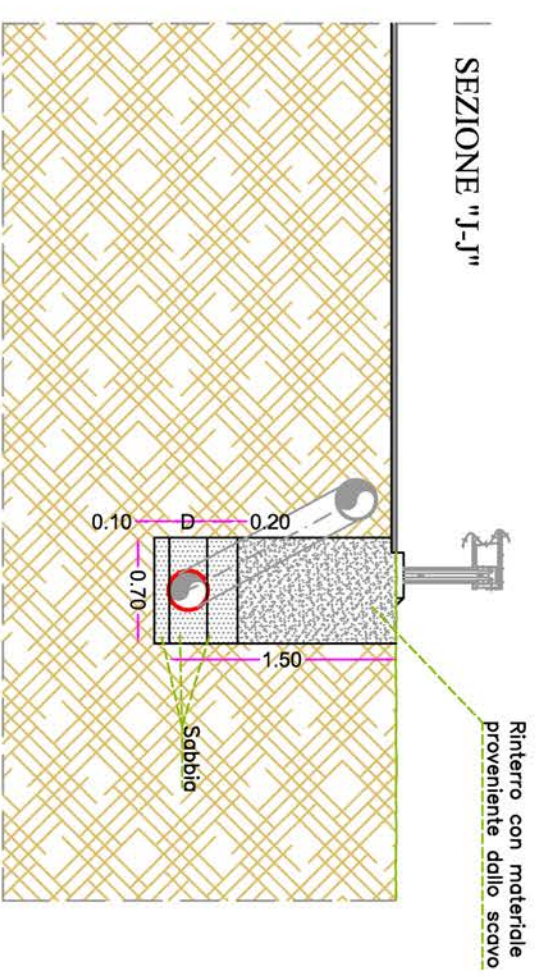

SEZIONE "Y-Y"

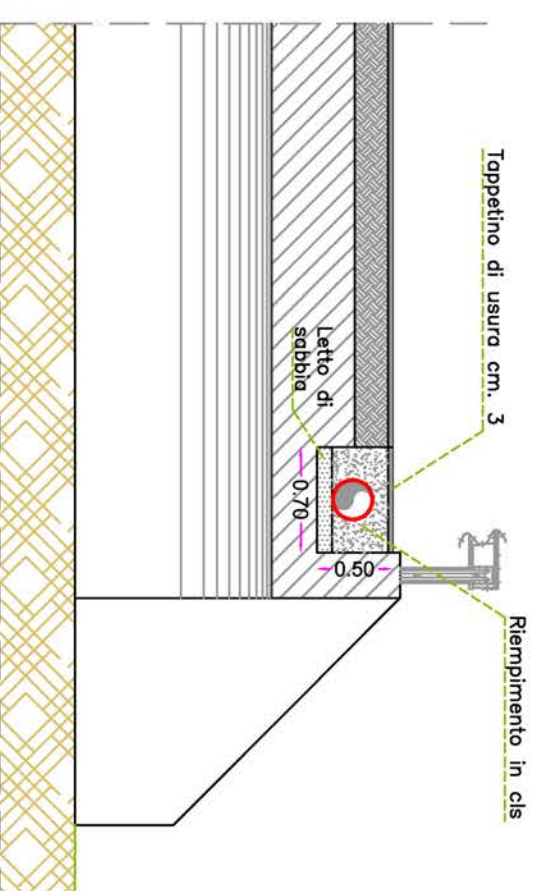

**PARTICOLARE COSTRUTTIVO ATTRAVERSAMENTO CANALE N°6 Km 7,325**  
 scala 1:50

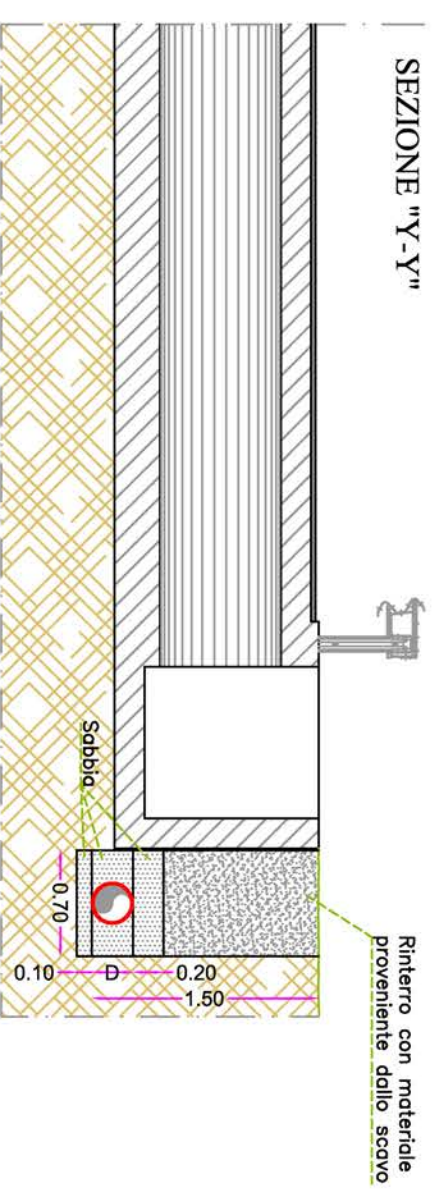
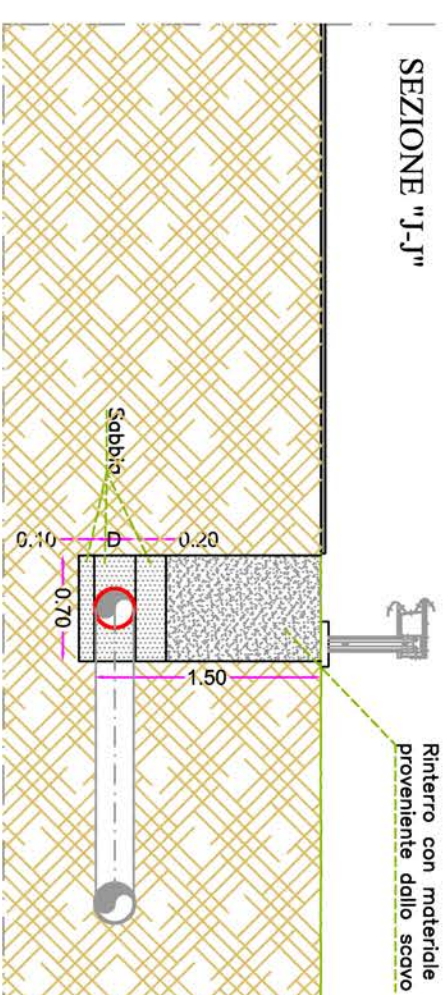
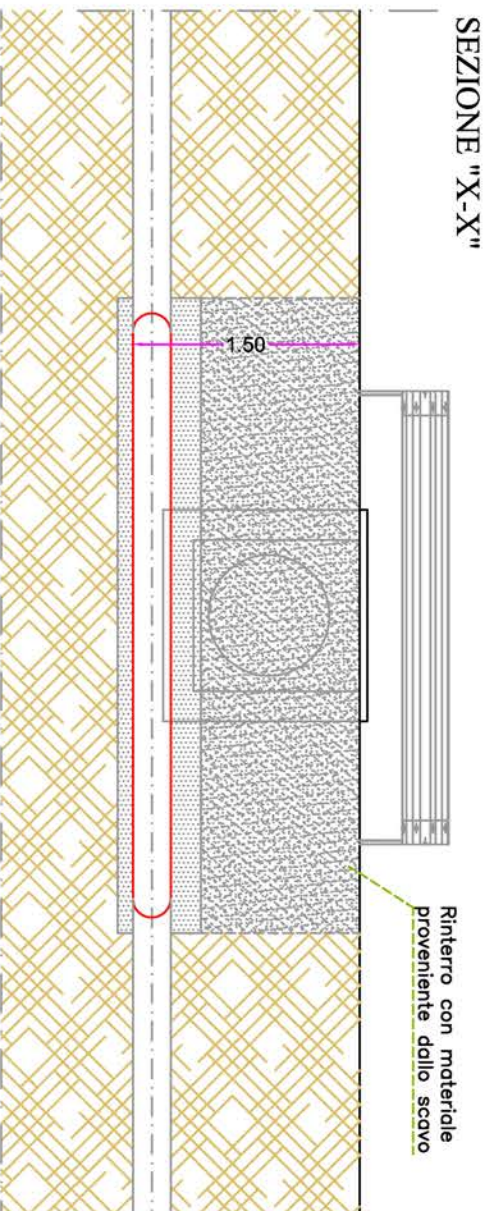
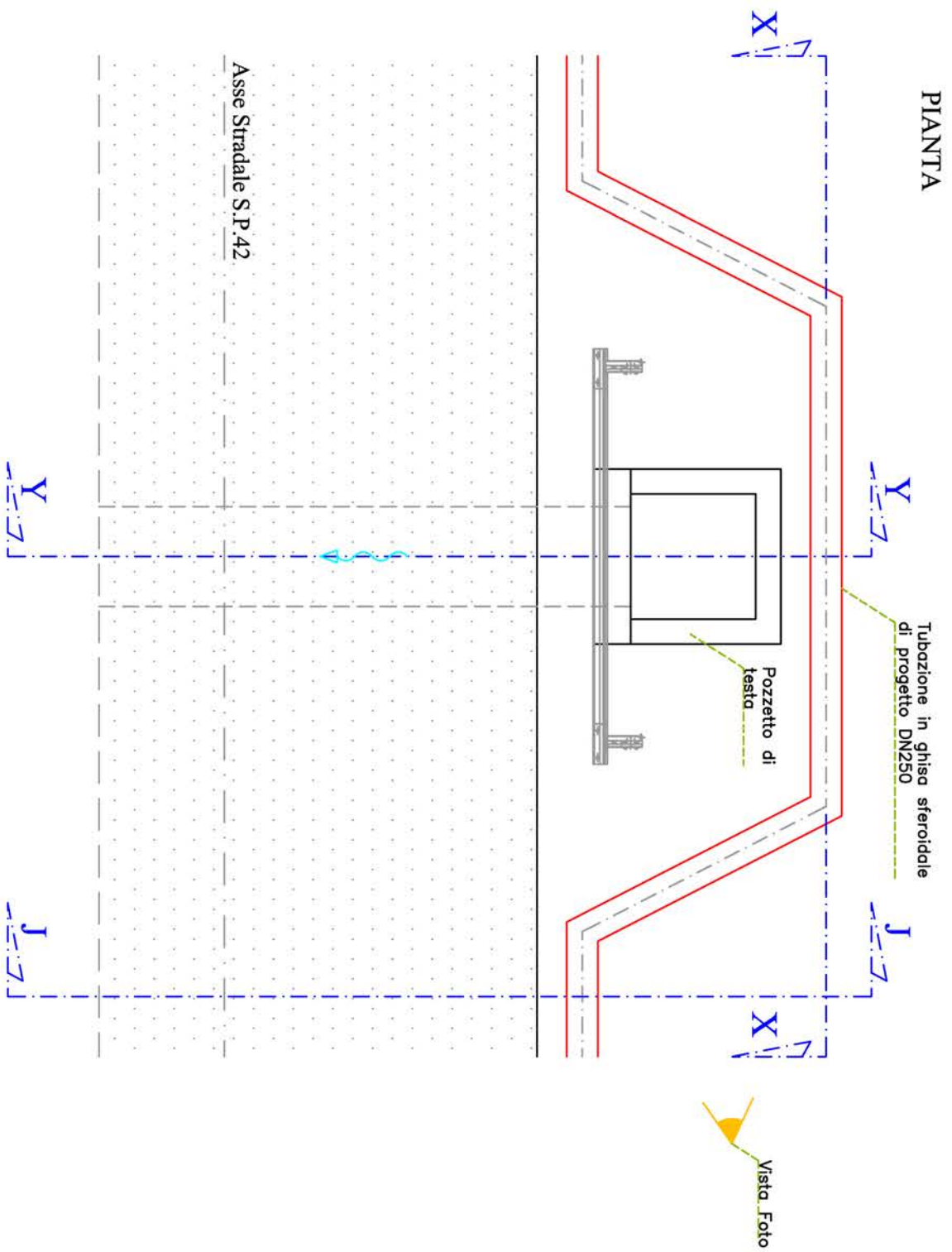



**PARTICOLARE COSTRUTTIVO ATTRAVERSAMENTO CANALE N°7 Km 9,715**  
 scala 1:50

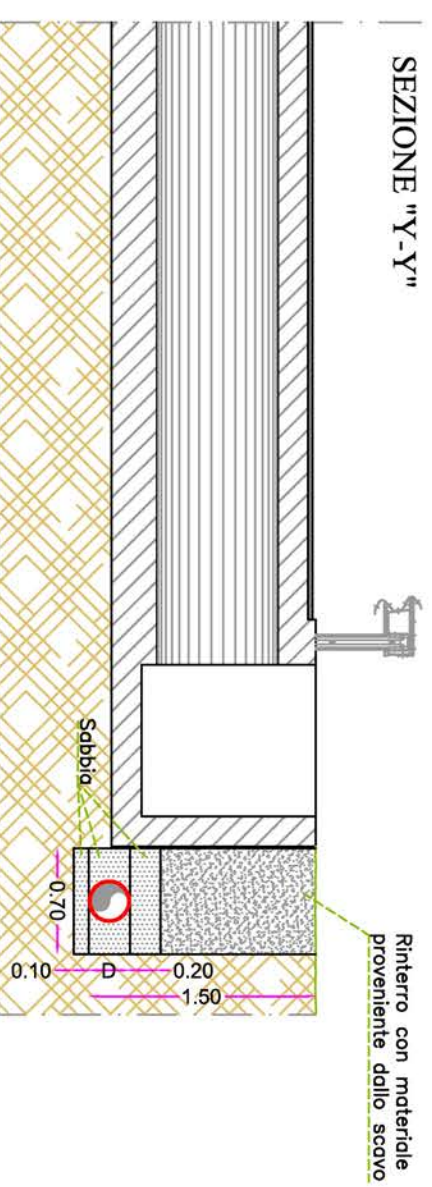
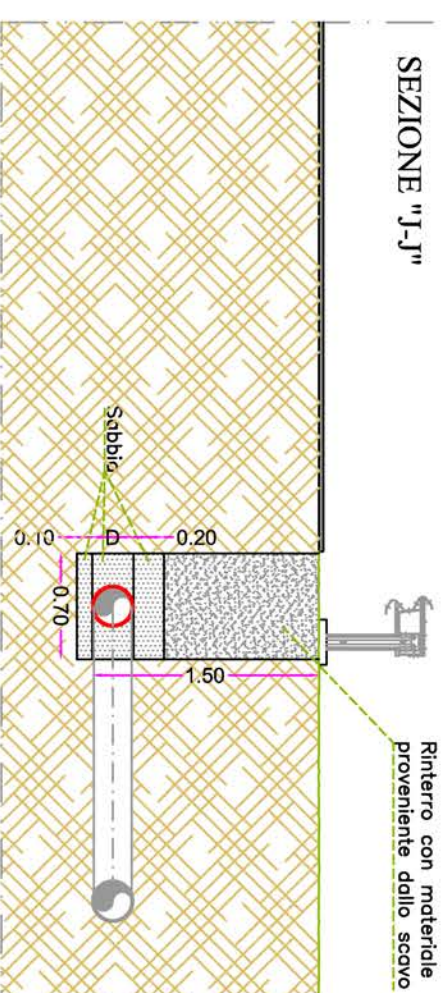
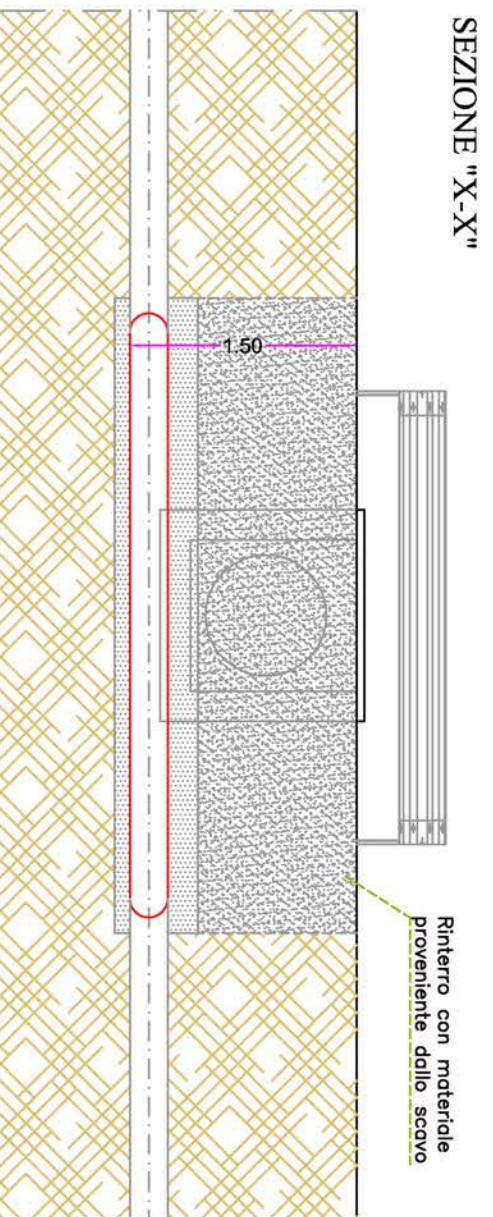
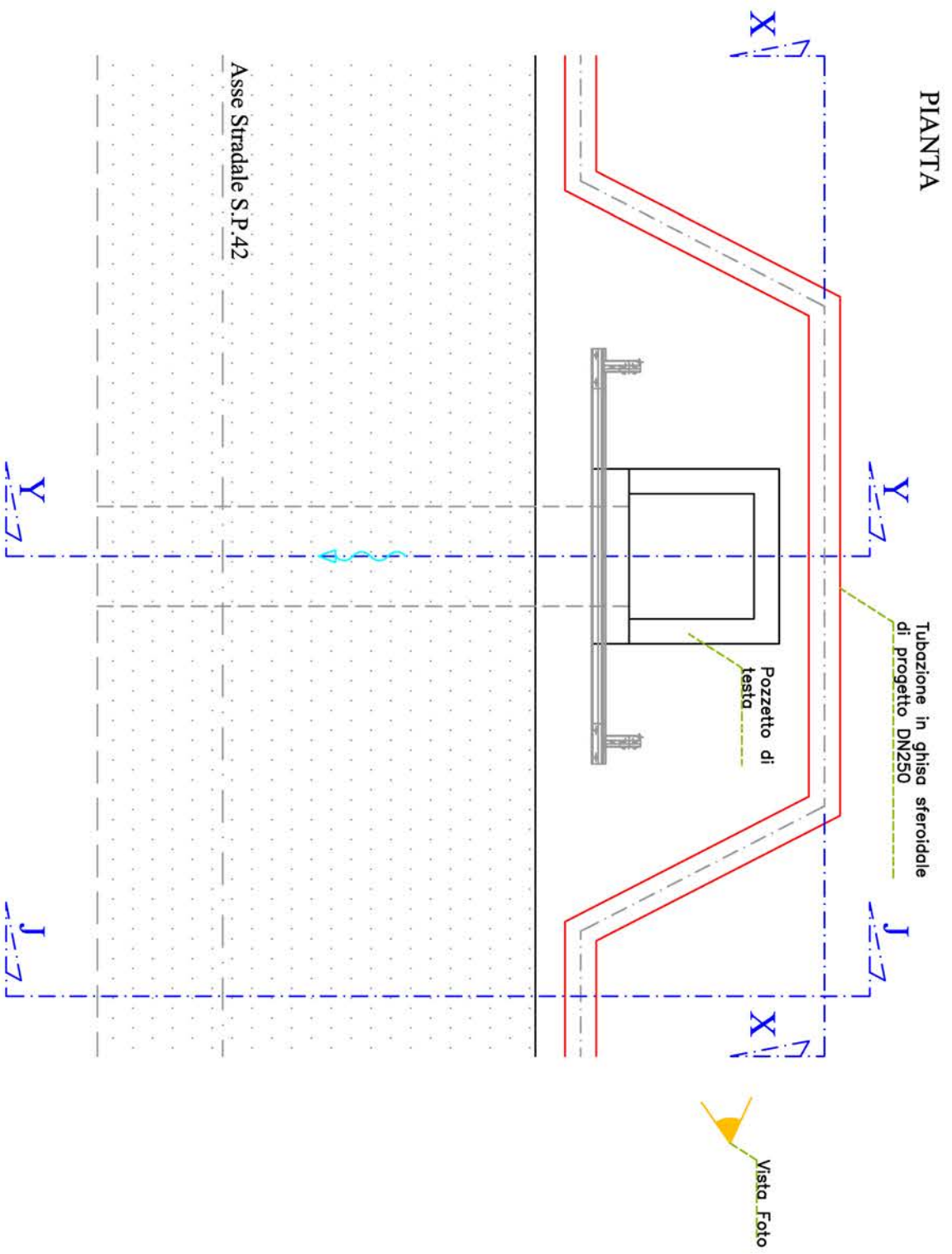

**PARTICOLARE COSTRUTTIVO ATTRAVERSAMENTO CANALE N°8 Km 10,820**  
 scala 1:50

PIANTA

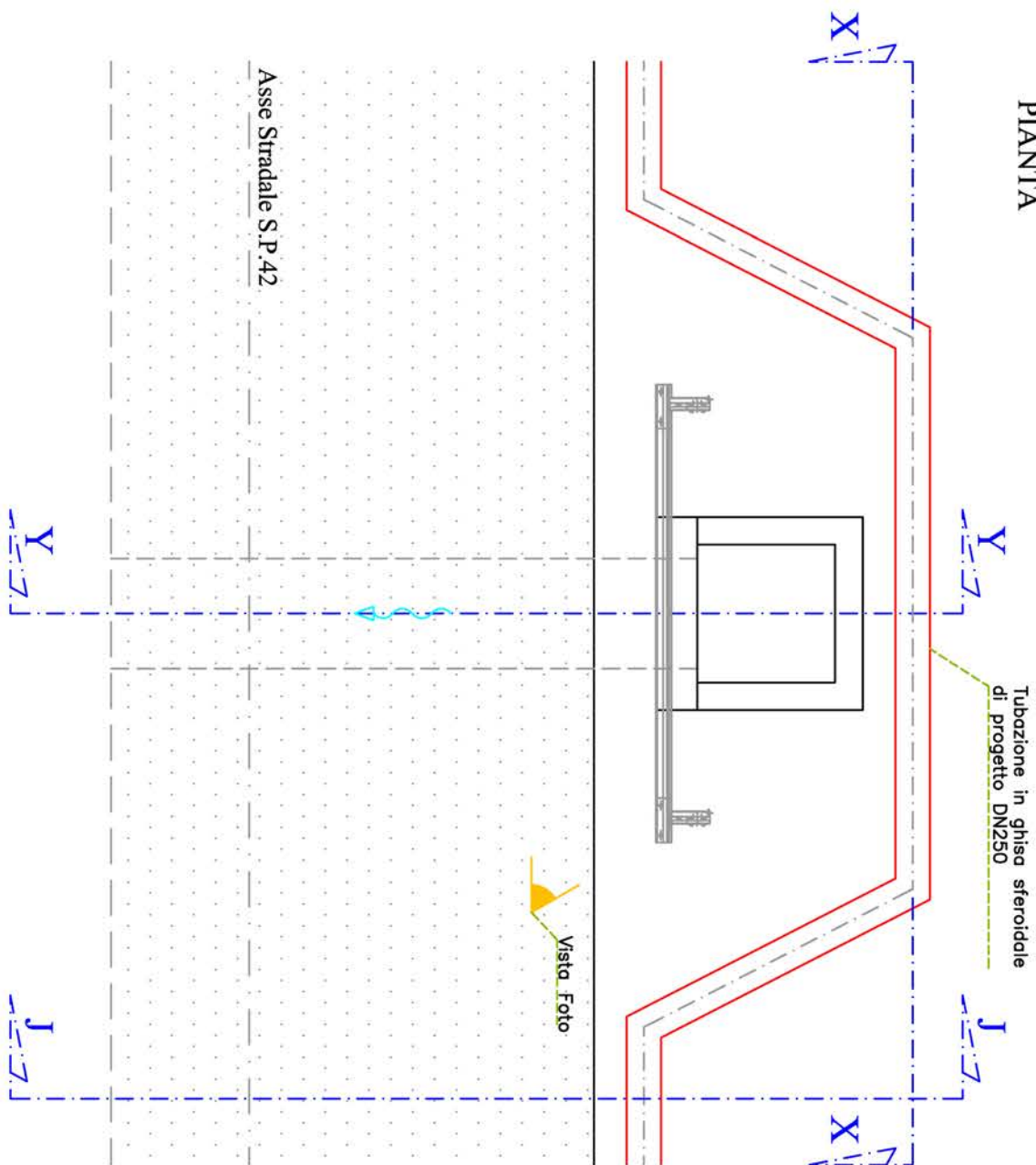

SEZIONE "X-X"



FOTO CANALE N°8



SEZIONE "J-J"

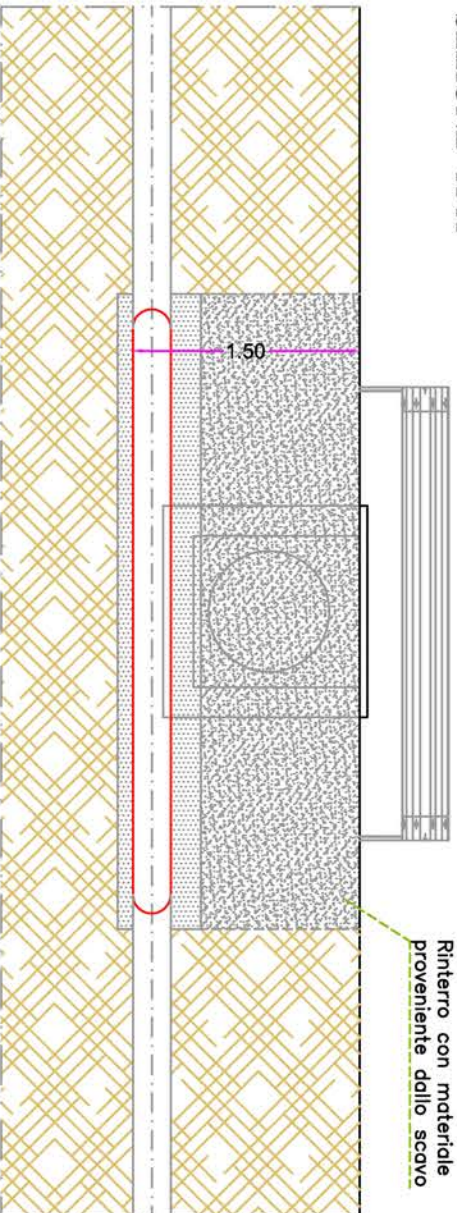
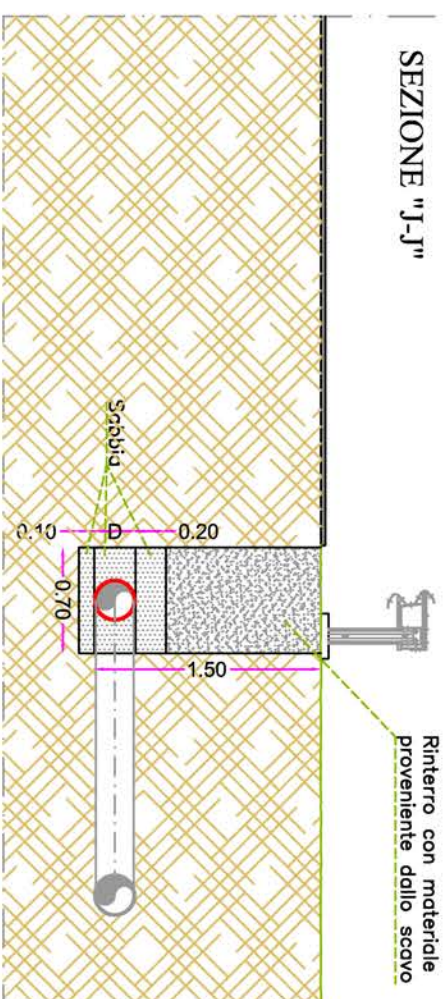

SEZIONE "Y-Y"

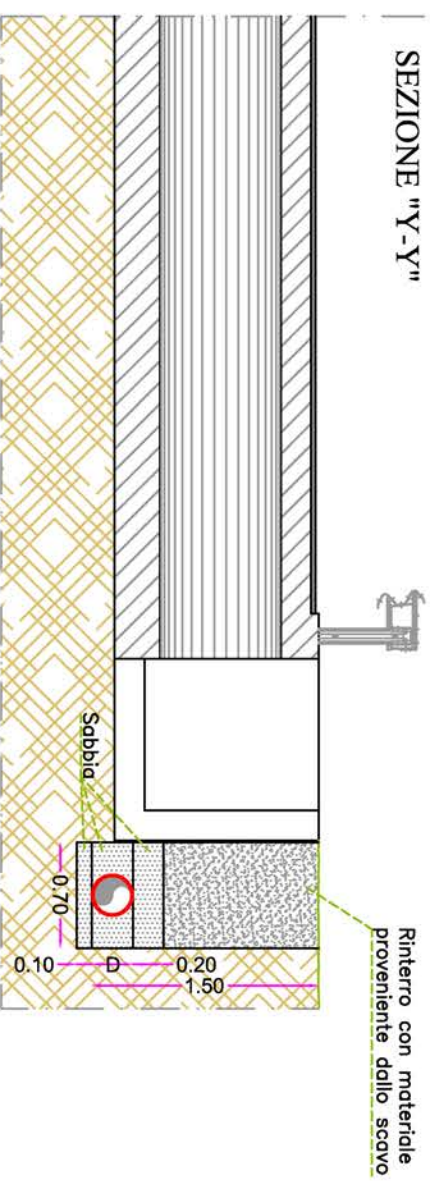

**PARTICOLARE COSTRUTTIVO ATTRAVERSAMENTO CANALE N°9 Km 11,080**  
 scala 1:50

PIANTA

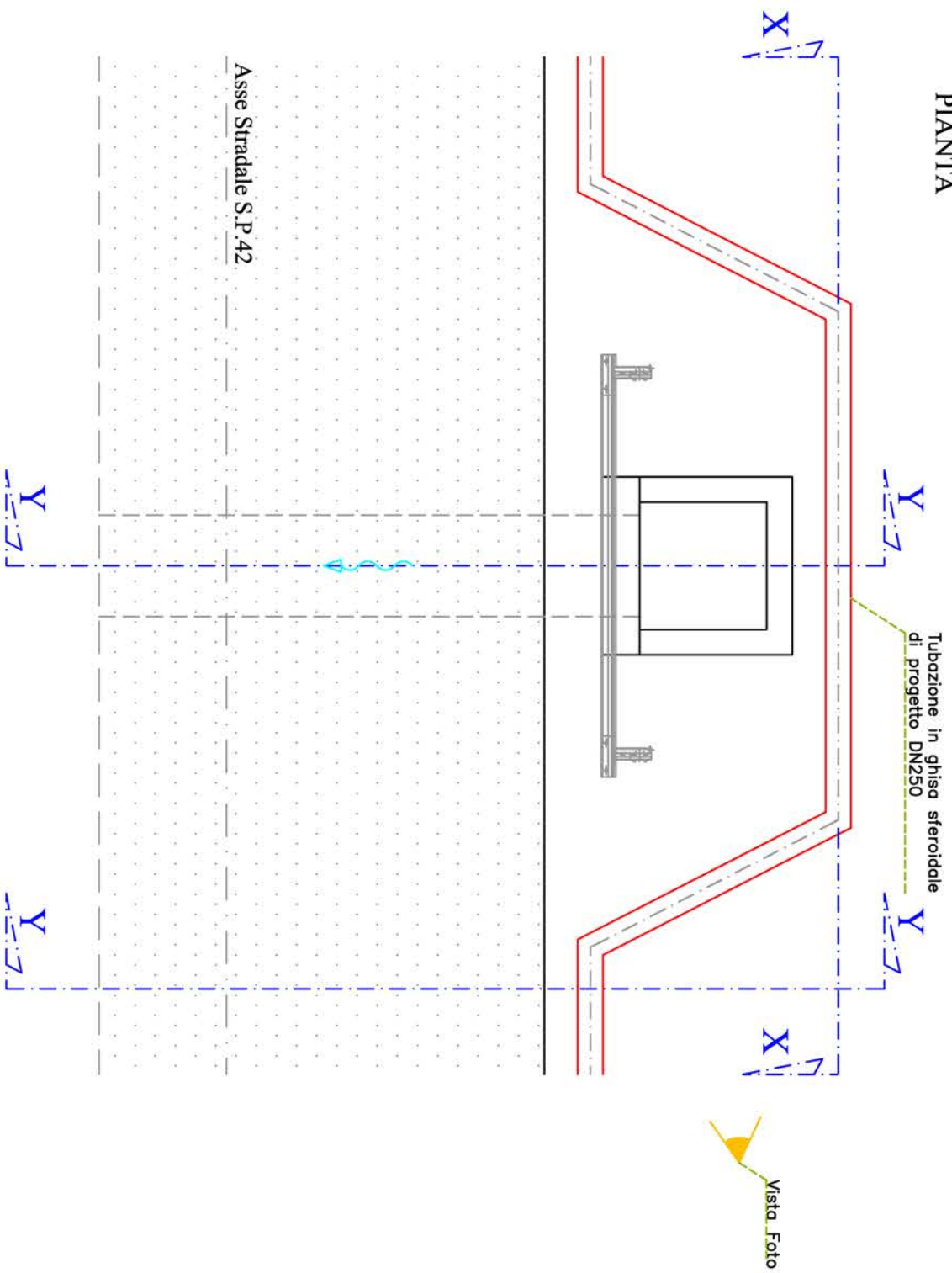

SEZIONE "X-X"



FOTO CANALE N°9



SEZIONE "J-J"

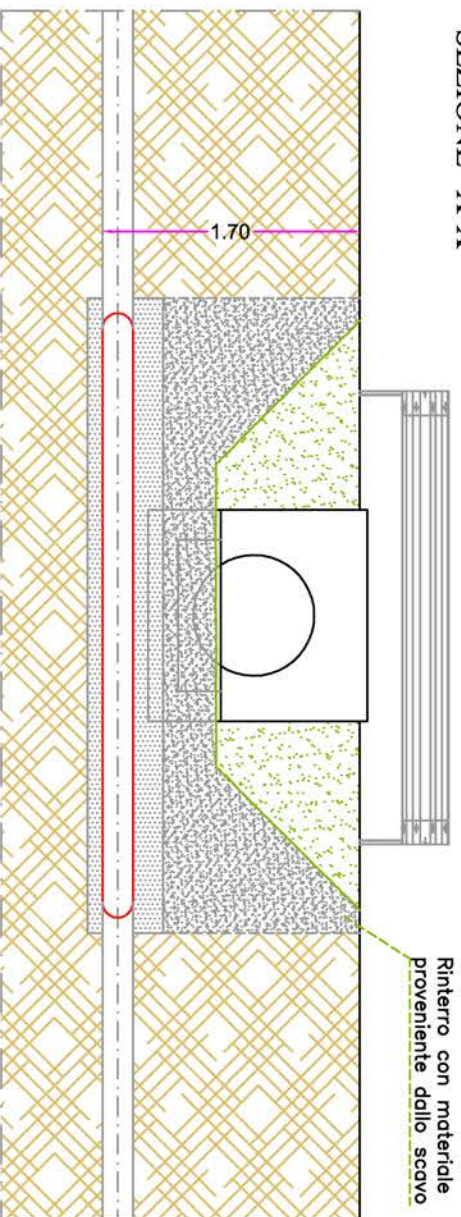
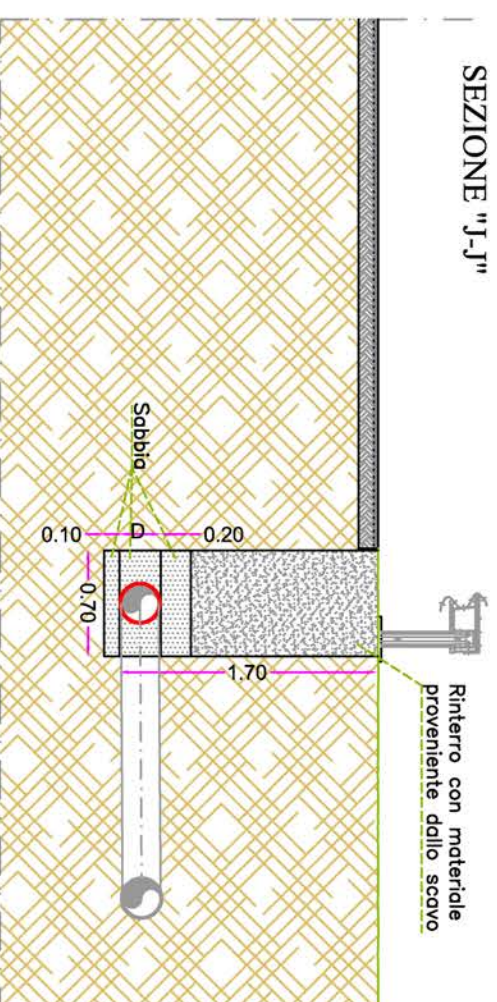

SEZIONE "Y-Y"

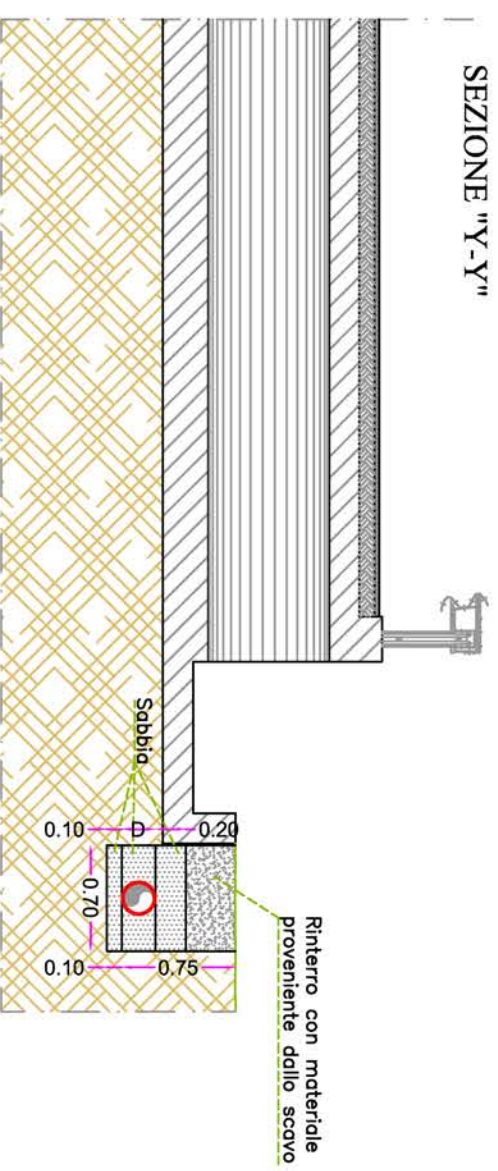

**PARTICOLARE COSTRUTTIVO ATTRAVERSAMENTO CANALE N°10 Km 11,355**  
 scala 1:50

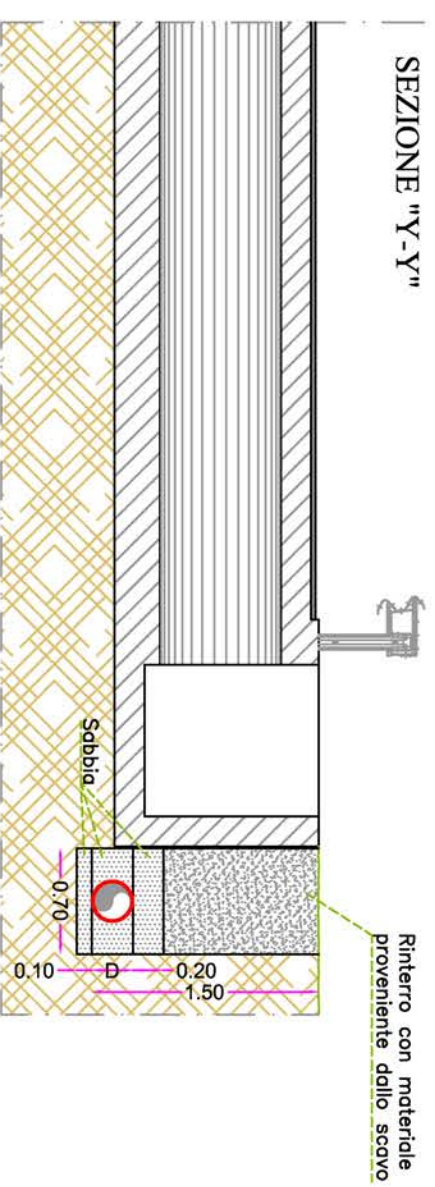
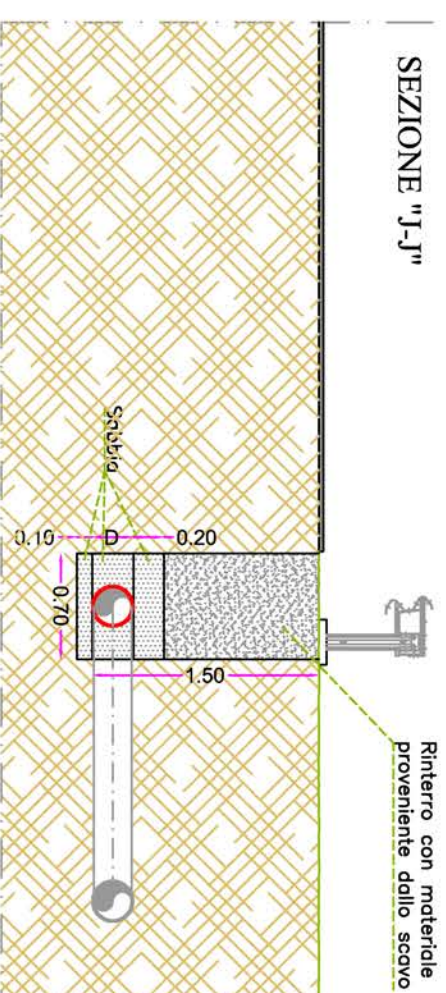
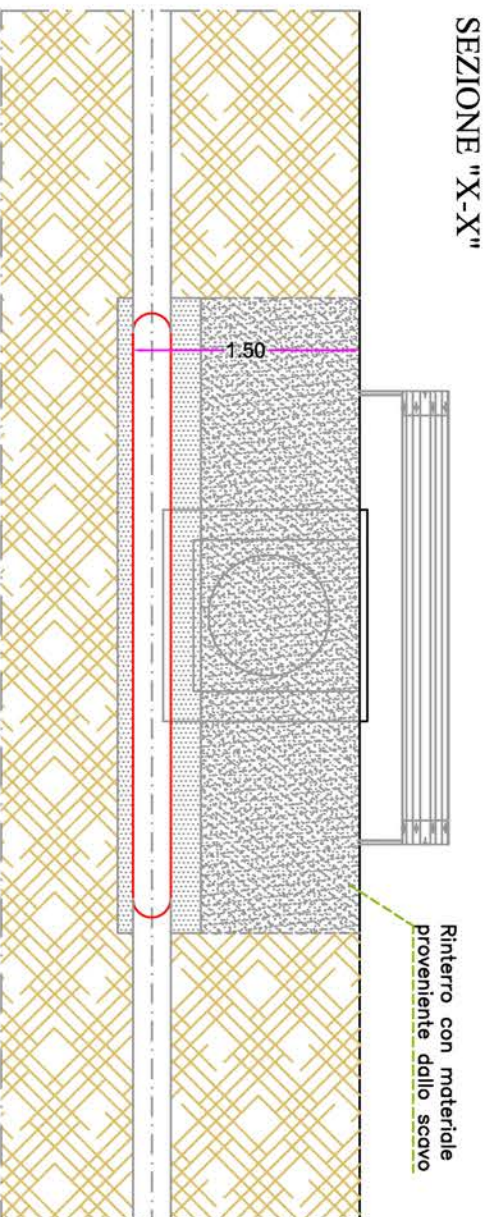
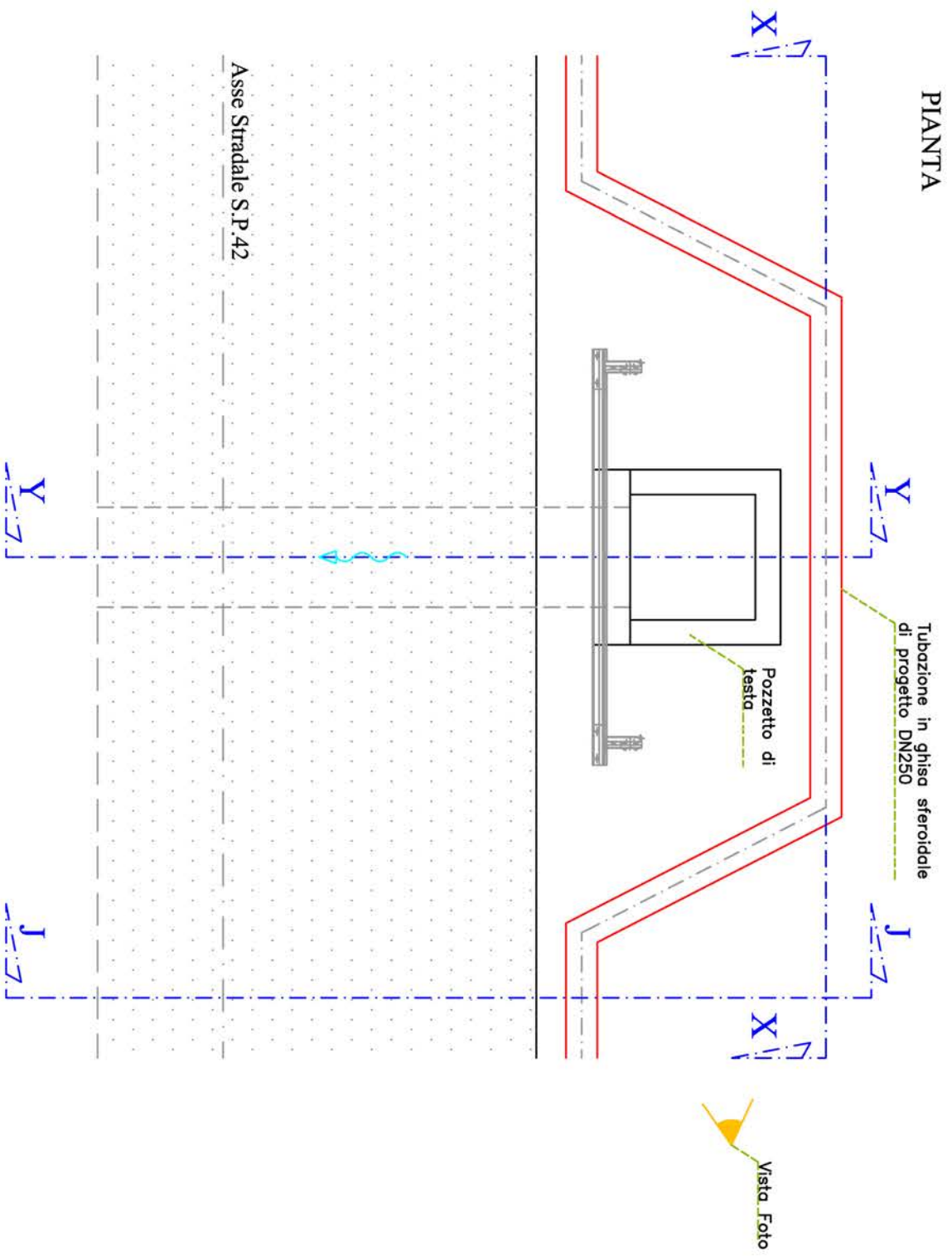

**PARTICOLARE COSTRUTTIVO ATTRAVERSAMENTO CANALE N°11 Km 12,655**  
 scala 1:50

